

CHASSIS SUPPORT DETAIL (MOBILE UP)

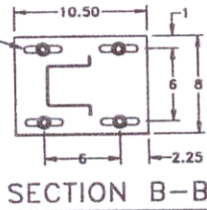
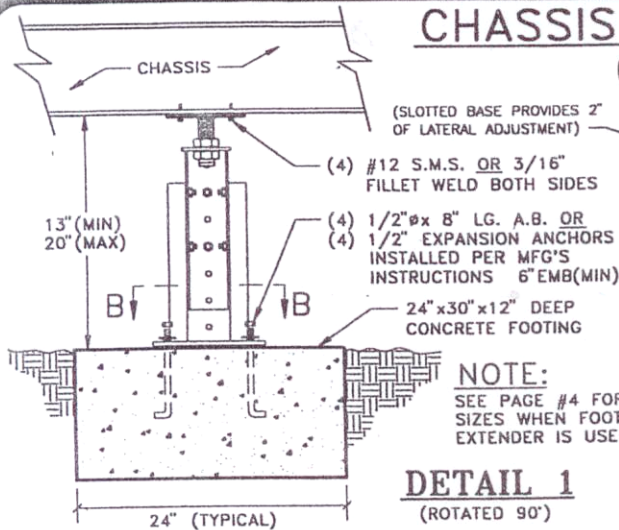

FRAME STIFFNER DETAIL

ALTERNATIVE: (2) #12 S.M.S. OR WELD

(2) #12 S.M.S.
ANGLE IRON
1 1/2" x 1 1/2" x 3/16"

NOTE: USE STIFFNER IF OUTRIGGER OR CROSS MEMBER DO NOT OCCUR WITHIN 12" OF STANCHION (TYP)

3/8-16UNC-1 1/2 LONG BOLT & NUT (4) EA. REQ'D.

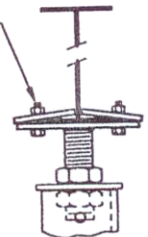

ALTERNATIVE BOLT-ON TOP

DETAIL 1 (ROTATED 90°)

RIDGE BEAM SUPPORT DETAIL

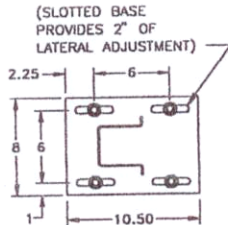
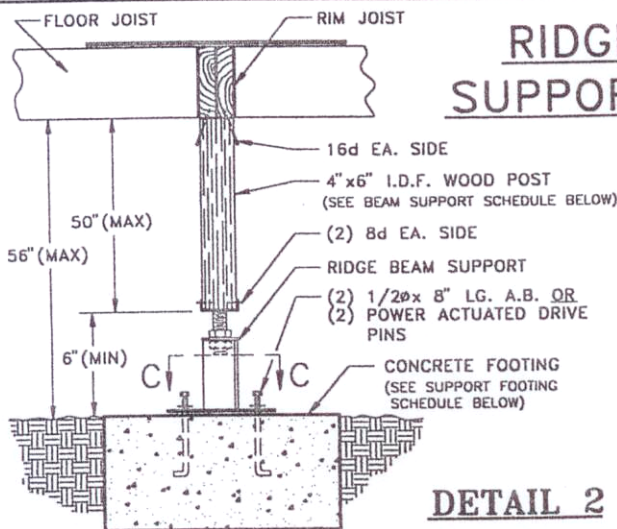

SECTION C-C

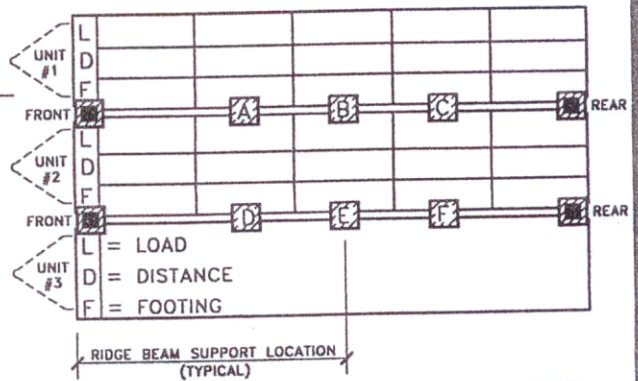

NOTE: CONSULT MANUFACTURER'S SET-UP INSTRUCTIONS FOR RIDGE BEAM LOADS AND LOCATIONS. (SEE NOTE #5 OF GENERAL NOTES)

DETAIL 2

BEAM SUPPORT SCHEDULE

(MAXIMUM LOAD PER RIDGE BEAM SUPPORT)

ABESCO MODEL NUMBER	NUMBER OF POSTS	MAXIMUM LOAD (lbs)
104	1	6000
105	2	12000

NOTE: (a) ALL POSTS TO BE 4" x 6" #3H.F. OR BETTER
(b) IF LOAD EXCEEDS 12000 LB.--THEN USE A COMBINATION OF MODELS #104 AND #105

SUPPORT FOOTING SCHEDULE

(RIDGE BEAM SUPPORT FOOTING)

LOAD TO FOOTING (lbs)	FOOTING SIZE ("x"x12"dp)	LOAD TO FOOTING (lbs)	FOOTING SIZE ("x"x12"dp)	LOAD TO FOOTING (lbs)	FOOTING SIZE ("x"x12"dp)
1000	12" x 12"	7000	32" x 32"	13000	44" x 44"
2000	17" x 17"	8000	34" x 34"	14000	45" x 45"
3000	21" x 21"	9000	36" x 36"	15000	47" x 47"
4000	24" x 24"	10000	38" x 38"	16000	48" x 48"
5000	27" x 27"	11000	40" x 40"	17000	50" x 50"
6000	30" x 30"	12000	42" x 42"	18000	51" x 51"

NOTE: (a) IF FOOTING SIZE IS 36" x 36" x 12" OR BIGGER USE (3)-#4 REBAR E.W.
(b) IF FOOTING SIZE IS 48" x 48" x 12" OR BIGGER USE (4)-#4 REBAR E.W.

INTERMEDIATE CHASSIS SUPPORTS

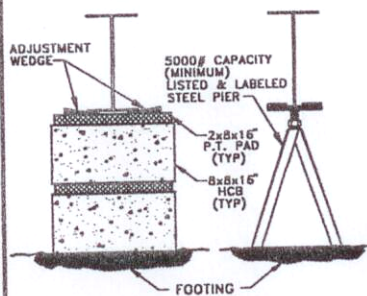

INTERMEDIATE SUPPORT TYPES

DETAIL 3

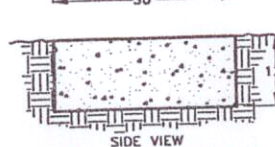
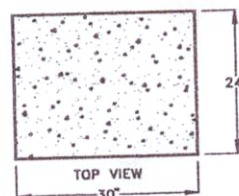

3 INTERMEDIATE CHASSIS SUPPORT

5,000 LB. CAPACITY (MIN) STEEL PIER OR 8" x 8" x 16" HCB BLOCK ON 24" x 30" CONCRETE FOOTING (SEE NOTE #7 OF GENERAL NOTES)

OR (2) 2" x 12" x 30" P.T. PAD WITH 2" x 12" x 24" P.T. CROSS PAD

OR ON ABESCO'S BEARING PAD'S ARRANGED TO PROVIDE 4,753 LB. CAPACITY. (3 PAD CONFIGURATION FROM SPA 250-1)

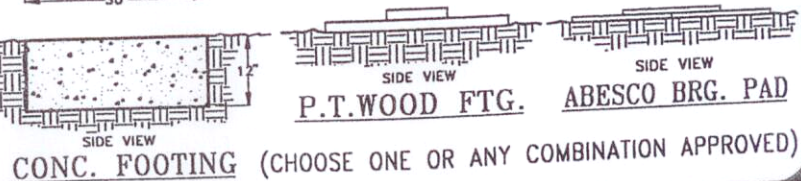
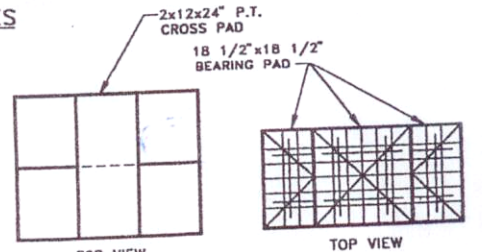

CONC. FOOTING (CHOOSE ONE OR ANY COMBINATION APPROVED)

ABESCO FOUNDATION DWG. 3 OF 7

