

SECTION A-A

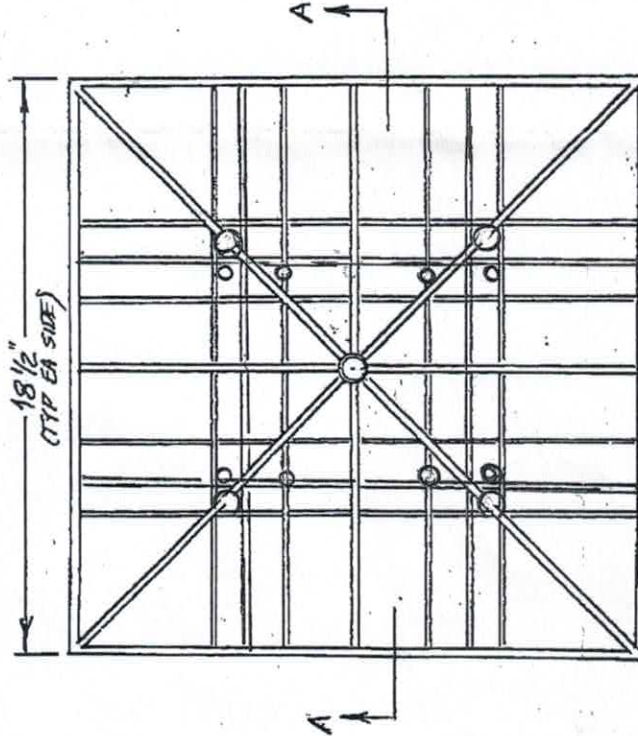

PLAN VIEW

ABESCO PLASTIC PAD
PART NO. 503

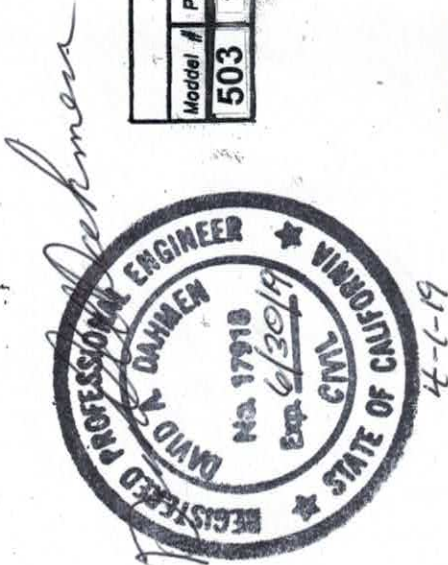

Plastic Foundation Pad			
MAXIMUM PIER LOADS IN POUNDS BASED ON SOIL VALUES			
Model #	Pad Configuration	Pad Area (Sq. Ft.)	1000 per Sq. Ft.
503	18.5" x 18.5"	2.37	2376
			3565
			4753

GENERAL NOTES:

1. PLASTIC PADS CAN BE USED WITH METAL PIERS OR CONCRETE BLOCKS.
2. INSTALLER IS RESPONSIBLE FOR DETERMINING SOIL BEARING CAPACITY
3. SECURE METAL PIERS TO PAD w/ 2-#14 x 1-1/2" SCREWS **
4. PADS TO BE PLACED WITH OPEN SIDE UP.

** NOT REQUIRED FOR COMMERCIAL COACH SUPPORTS

CAPITOL ENGINEERING LAB.'S, INC
LISTING NUMBER 5911

APPROVAL

MOBILE/HOME & ACCESSORY STRUCTURE BUILDING COMPONENT
HEALTH AND SAFETY CODE, DIVISION 13, PART 2
APPROVED

Approval does not authorize or approve any omission or deviation
from requirements of applicable State laws and regulations.

STATE OF CALIFORNIA
DEPARTMENT OF HOUSING AND COMMUNITY DEVELOPMENT
DIVISION OF CODES AND STANDARDS

By: *[Signature]* Date: 4/2/19
BP NO. 07-09

This Approval Expires 12/18/20

REVISIONS:

DATE: 12/13/08
JOB NUMBER: 108-1371

Pacific Consulting Engineers
2500 1st Ave., Suite # 105
Berkeley, CA 94702
Phone: (916) 894-0028
Fax: (916) 894-0029

DRAWN BY: TLW

ABESCO
5851 FLORIN-PERKINS ROAD
SACRAMENTO, CA 95828
PH: (800) 383-8831
FAX: (916) 383-5207